



Republic of the Philippines  
Province of Albay  
CITY OF TABACO

## Bids and Awards Committee

### SUPPLEMENTAL BID BULLETIN NO. 16-2024

**Supply, Delivery & Installation of Furniture and Fixtures at New SP Building,  
Karangahan Wellness Center, Bangkilingan, Tabaco City  
Contract ID No. 046-11-2024-GOODS-PB, ABC: Php 6,582,700.00  
PhilGEPS ITB Ref No. 11530022**

#### TO ALL CONCERNED:

Please be advised of the following Clarification/Amendments to the Bidding Documents of the foregoing Project, particularly the *Section I-Invitation to Bid and Section VI-Schedule of Requirements*, to wit:

#### *A. Section I-Invitation to Bid:*

ISSUE	CLARIFICATION/AMENDMENTS
<b>Paragraph 5</b> A complete set of Bidding Documents may be acquired by interested bidders on November 26-December 16, 2024 from given address and website/s below and upon payment of the applicable fee for the Bidding Documents, pursuant to the latest Guidelines issued by the GPPB, in the amount of <i>Twenty-Five Thousand Pesos (P 25,000.00)</i> .	<b>Paragraph 5</b> A complete set of Bidding Documents may be acquired by interested bidders on November 26-December 16, 2024 from given address and website/s below and upon payment of the applicable fee for the Bidding Documents, pursuant to the latest Guidelines issued by the GPPB, in the amount of <i>Ten Thousand Pesos (P 10,000.00)</i> .

#### *B. Section VI-Schedule of Requirements:*

Incorporating the hereto attached Layout Design as basis for the installation of furniture and fixtures (see attached)

This Supplemental Bid Bulletin No. 16-2024 is issued by the procuring entity to clarify, modify or amend items in the Bidding Documents. This shall form an integral part of the Bidding Documents.

For information and guidance of all concerned.

Issued this 4<sup>th</sup> day of December 2024 at Tabaco City.

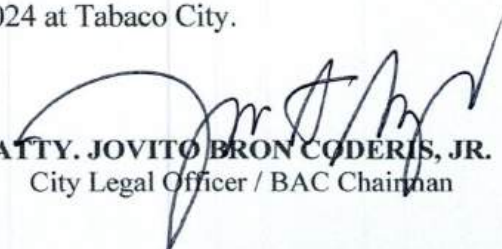
  
**ATTY. JOVITO BRON CODARIS, JR.**  
City Legal Officer / BAC Chairman



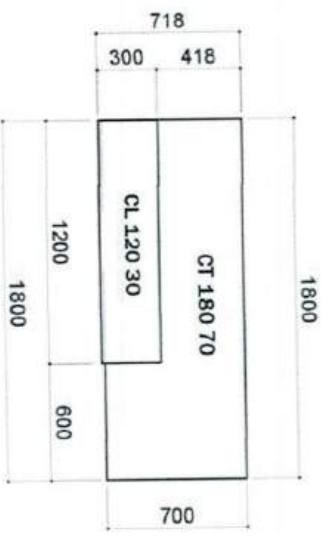

PLAN

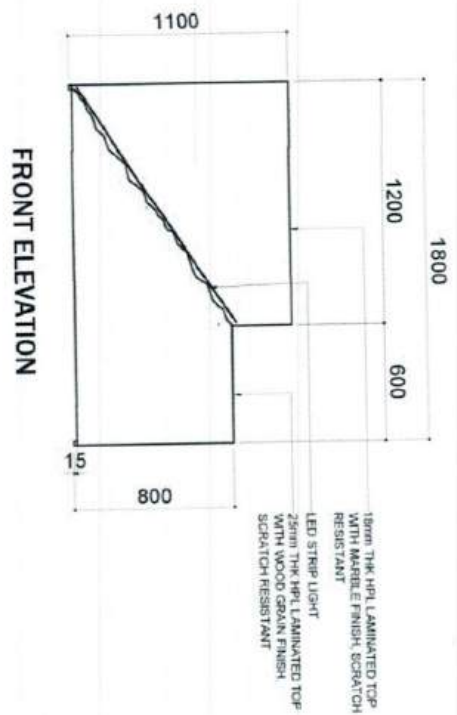

FRONT ELEVATION

18mm THK HPL LAMINATED TOP WITH MARBLE FINISH, SCRATCH RESISTANT  
 LED STRIP LIGHT  
 25mm THK HPL LAMINATED TOP WITH WOOD GRAIN FINISH SCRATCH RESISTANT

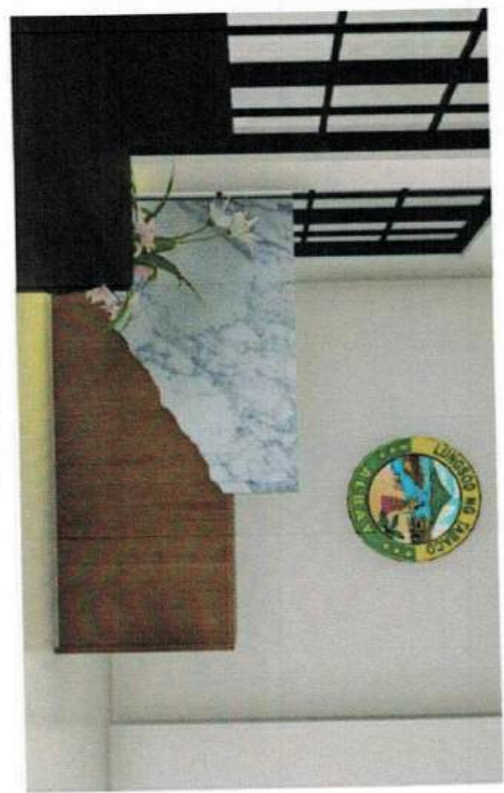

PERSPECTIVE



SIDE ELEVATION

18mm THK HPL LAMINATED TOP WITH MARBLE FINISH, SCRATCH RESISTANT  
 LED STRIP LIGHTS

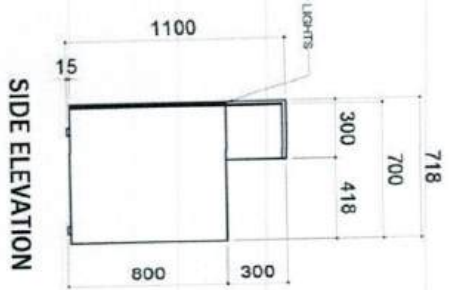

SIDE ELEVATION

RECEPTION DESK LAYOUT

1 - UNIT

**STAFF CHAIR;**

Ergonomic Designed Chairs with armrest, lockable rocking/tilting mechanism, with at least 50mm thick seat cushion made up of high density foam in fully upholstered black fabric, Backrest made up of mesh fabric, chrome base, backrest shall be bolted with sit and not welded, minimum weight capacity 350 lbs, can swivel 360 degrees.

Seat-W-49 x 52 x

H-90-102cm

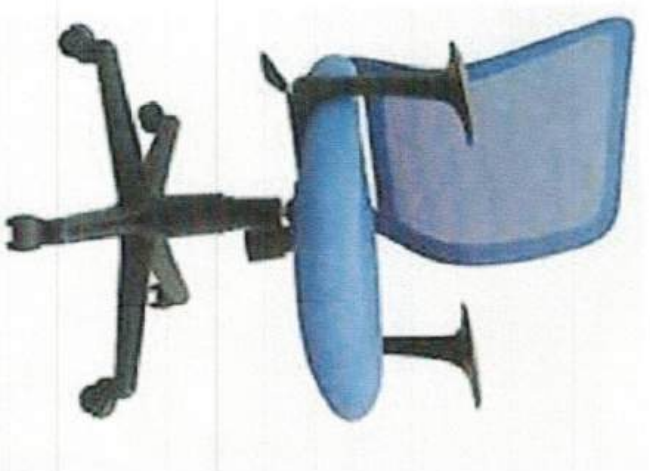

**STAFF CHAIR  
RECEPTION CHAIR (1-UNIT)**

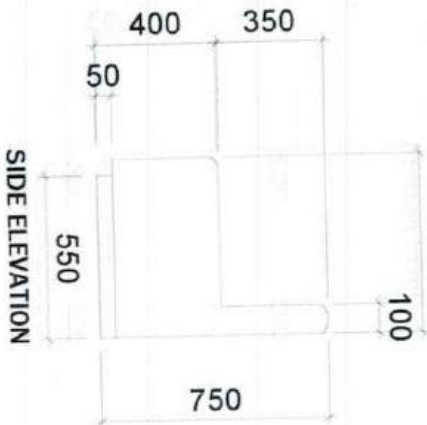
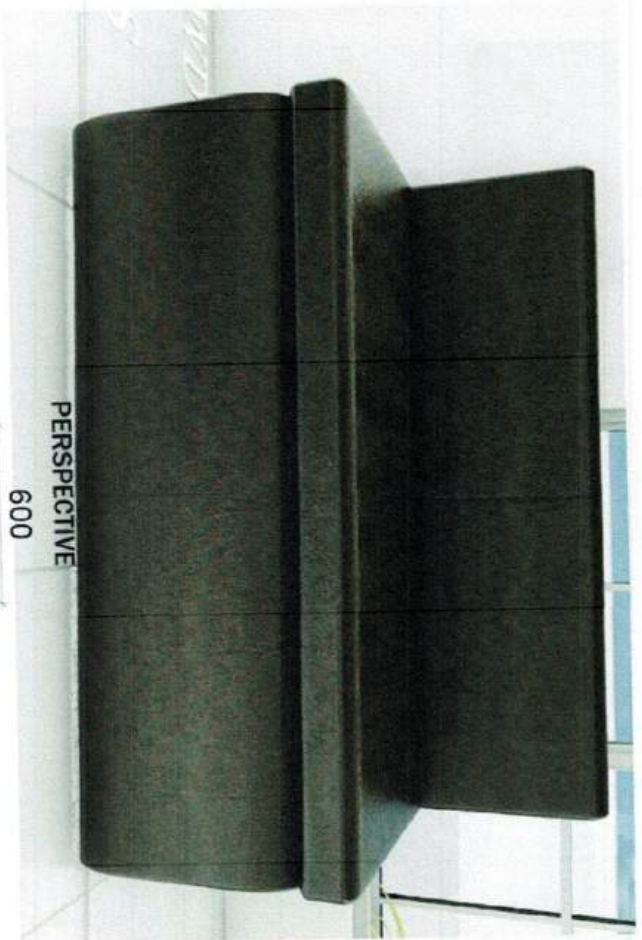
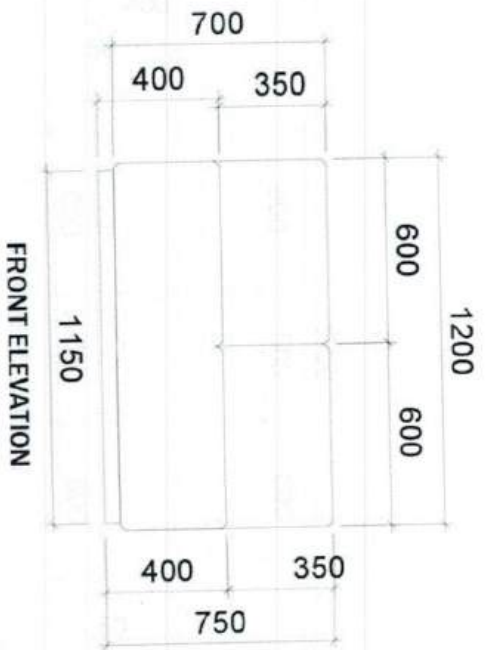
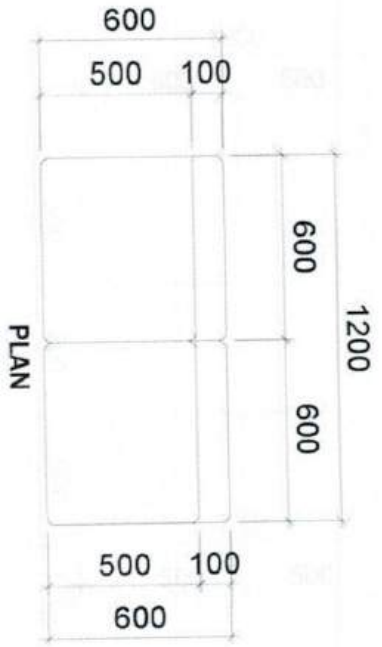

**TWO SEATER SOFA  
LAYOUT**

(1-UNIT)

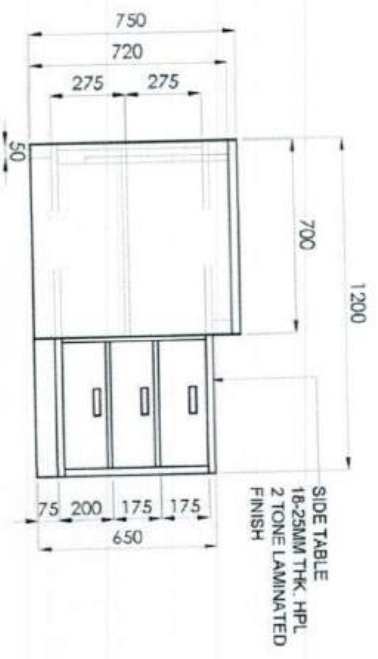
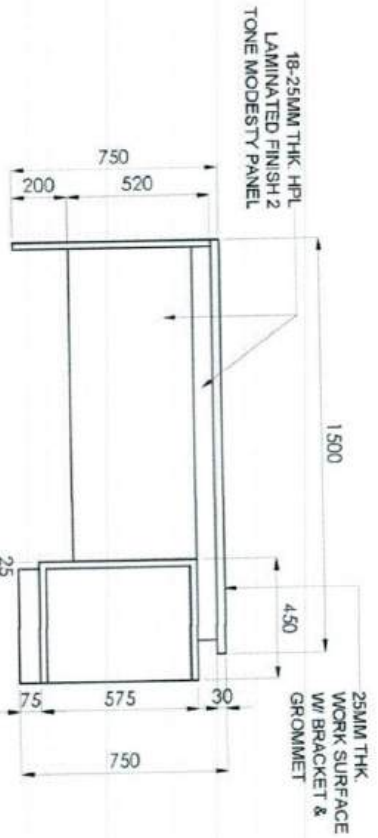

**VICE MAYOR'S TABLE LAYOUT**

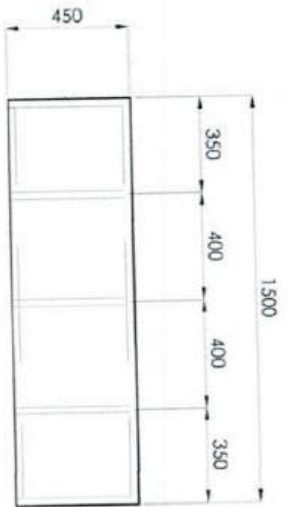

**PLAN**

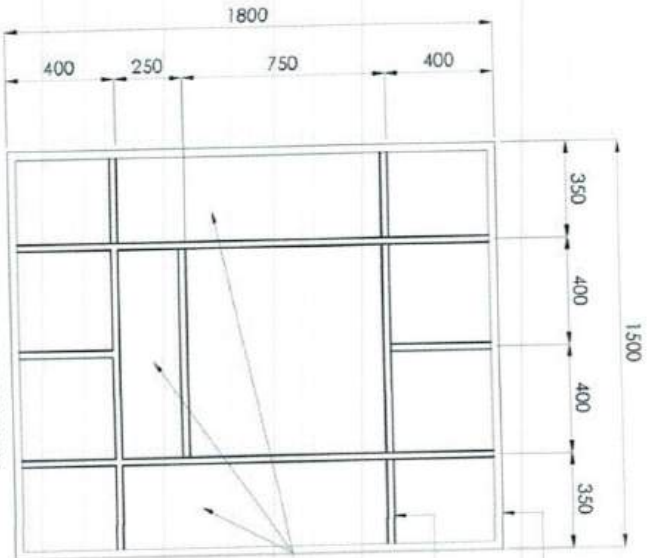

**FRONT ELEVATION**



3/4" THK. HPL LAMINATED BOARD

3/4" THK. HPL LAMINATED BOARD

3/4" THK. HPL LAMINATED BOARD DOOR OPENING (SCRATCH RESISTANT) WALLNUT

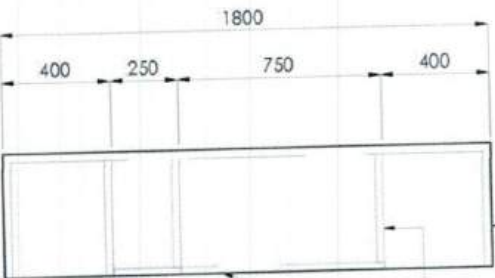

**SIDE ELEVATION**

3/4" THK. HPL LAMINATED BOARD

3/4" THK. HPL LAMINATED BOARD

3/4" THK. HPL LAMINATED BOARD DOOR OPENING (SCRATCH RESISTANT) WALLNUT

**BACK CABINET LAYOUT**

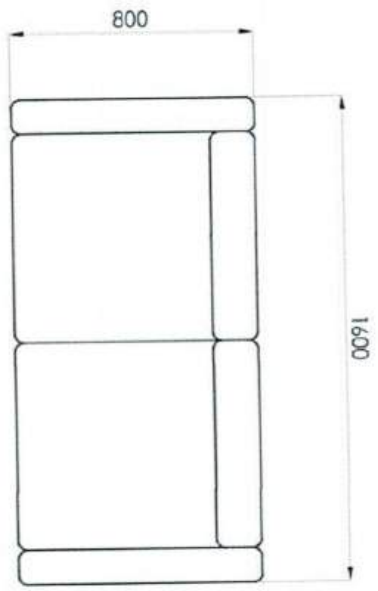

PLAN



PERSPECTIVE

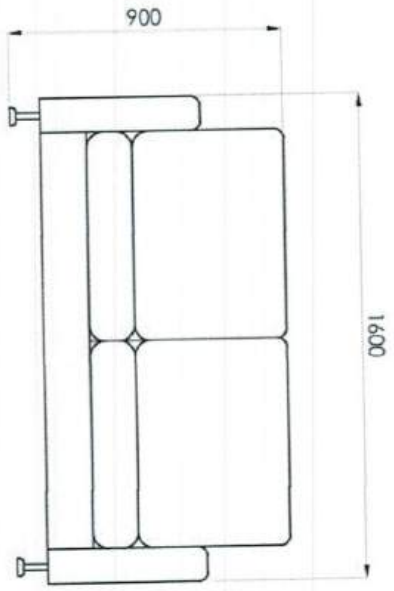

FRONT ELEVATION



SIDE ELEVATION

**TWO SEATER SOFA  
LAYOUT**

**EXECUTIVE CHAIR:**

Ergonomic Designed Chair with padded  
Armrest, lockable  
rocking/tilting and adjustable seat height  
using gas lift mechanism, with at least  
50mm thick seat  
cushion made up of high density foam in  
fully  
upholstered black leather finish, Backrest  
made up of leather, chrome base, backrest  
shall be bolted with sit and welded, can  
swivel 360 degrees. COLOR: Black,  
64(D)\*72(W)\*116-122.5(H)

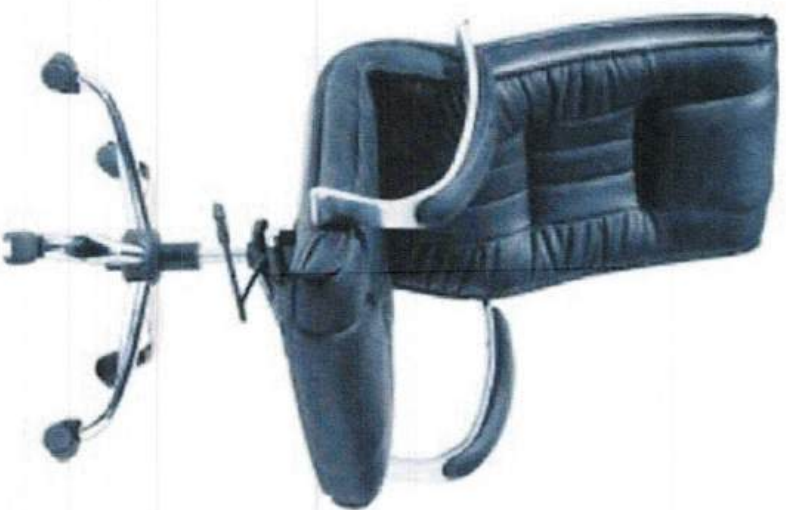

**VICE MAYOR EXECUTIVE CHAIR**

(1-UNIT)

**VISITOR CHAIR:**

High density foam on flame retardant, seat and backrest (Leatherette black finish) Leg: Chrome Sledbase: Backrest Height: Low backrest Others: With fixed armrest, square edge backrest Size: 64(D)\*65(W)\*109(H)



**VICE MAYOR VISITOR CHAIR**

(2- UNITS)



PLAN



PERSPECTIVE

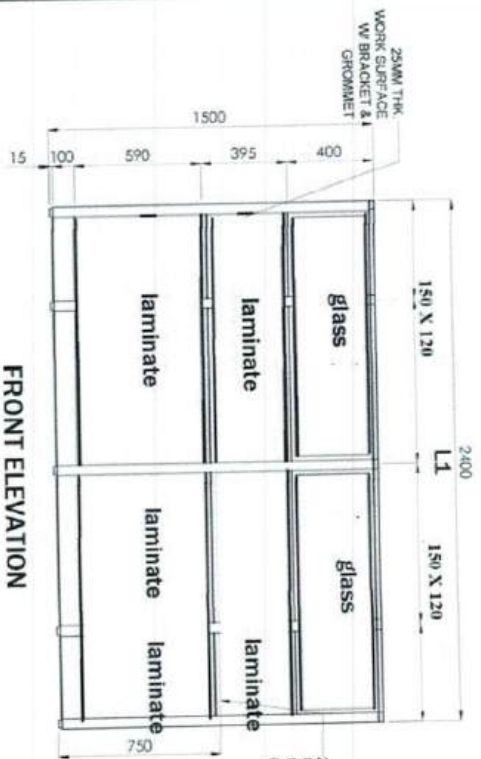

FRONT ELEVATION

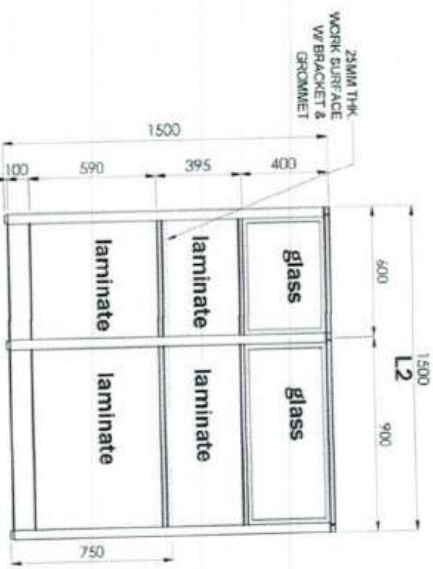

SIDE ELEVATION

**PARTITION TABLE LAYOUT**  
**VM- STAFF PARTITION**

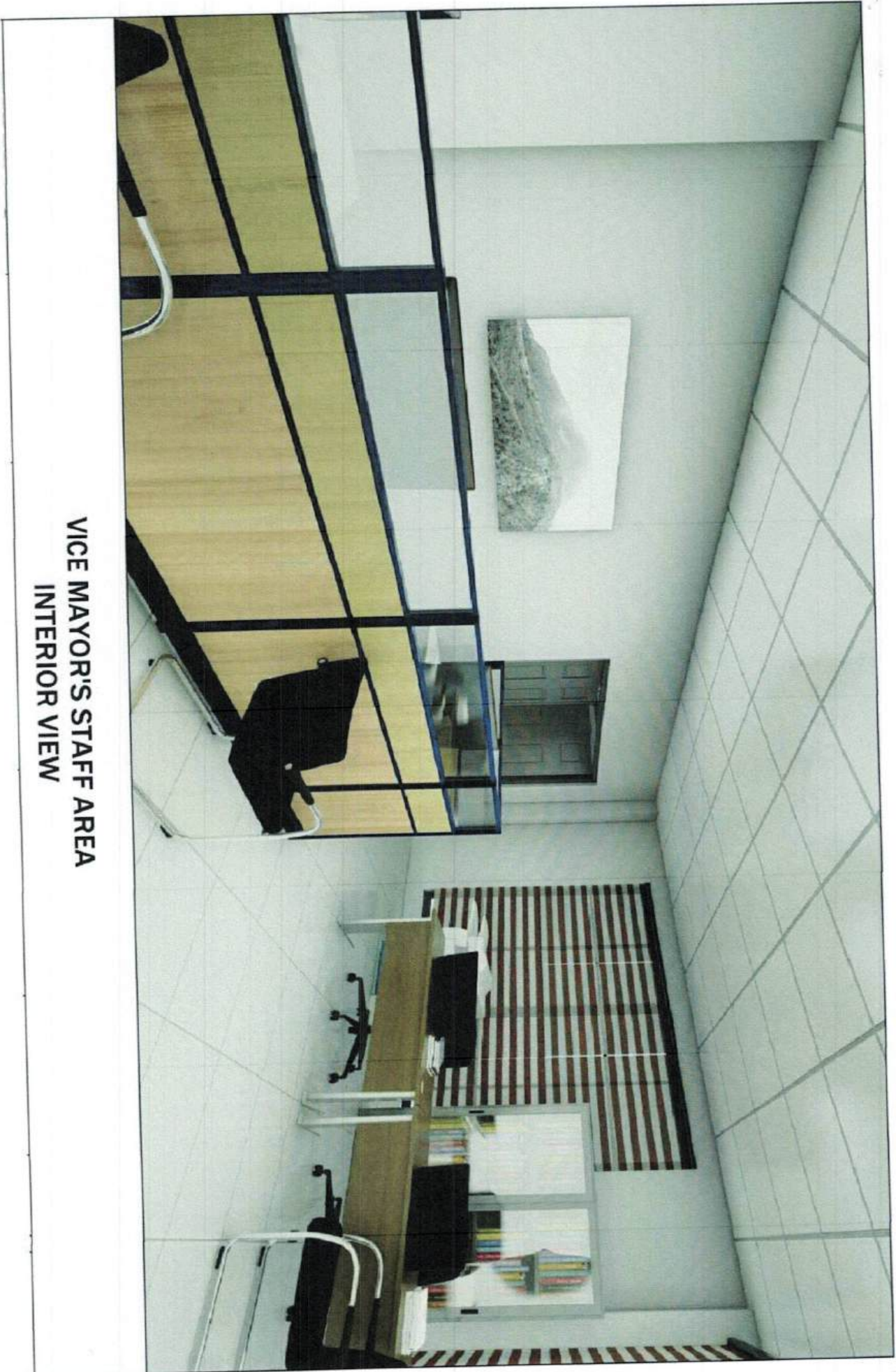

**VICE MAYOR'S STAFF AREA  
INTERIOR VIEW**

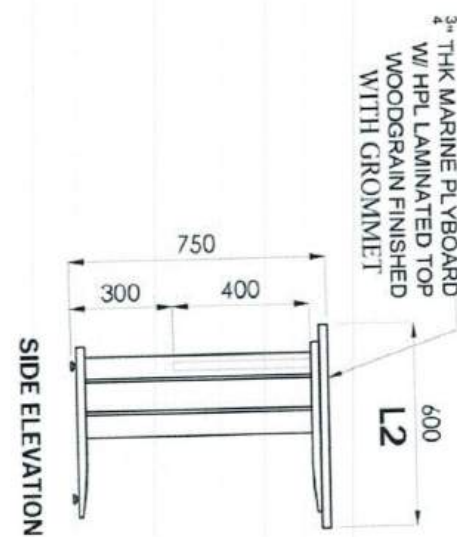
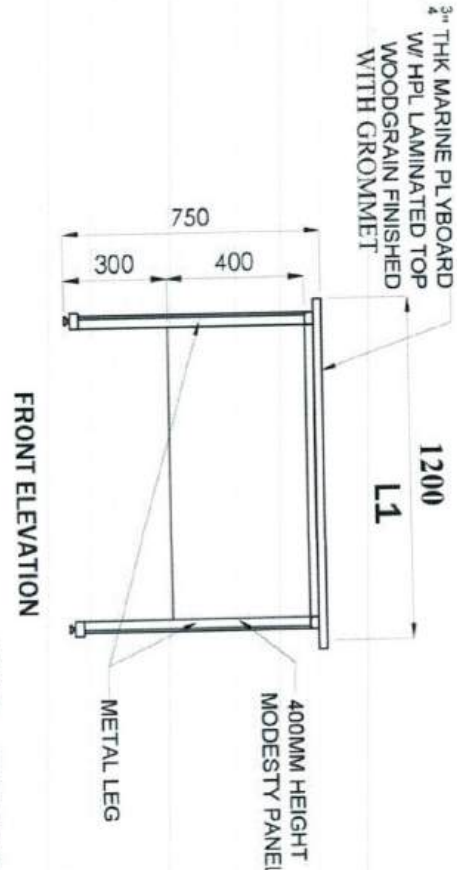
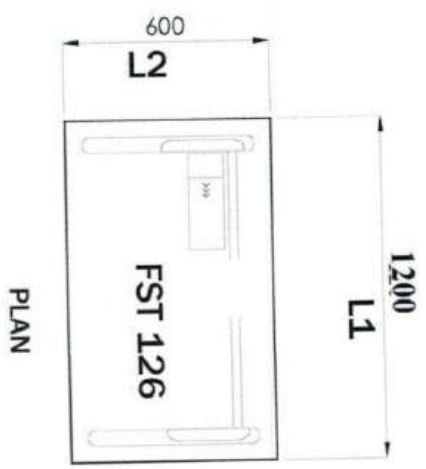

**VM FREE STANDING TABLE LAYOUT**

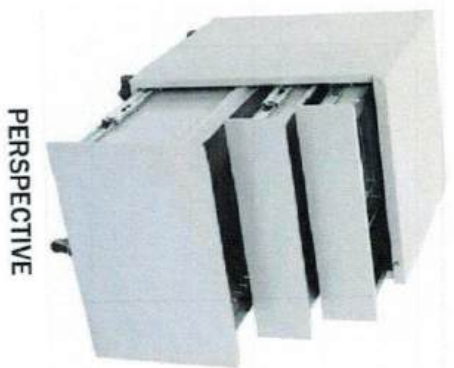
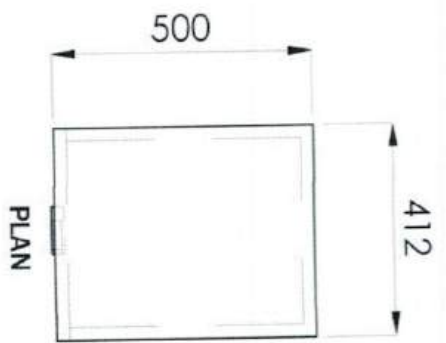

25MM THK. HPL LAMINATED  
BOARD DOOR OPENING  
(SCRATCH RESISTANT)  
WALLNUT

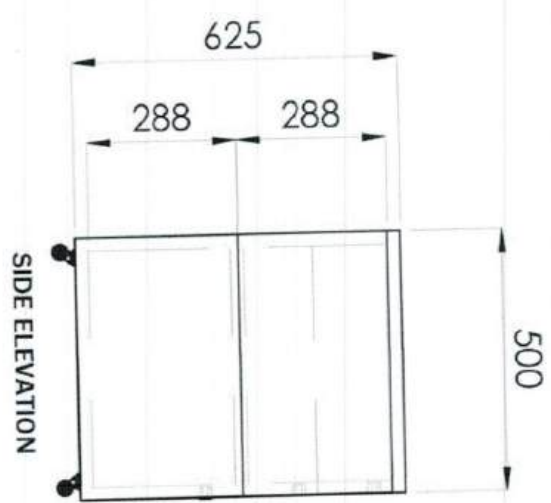
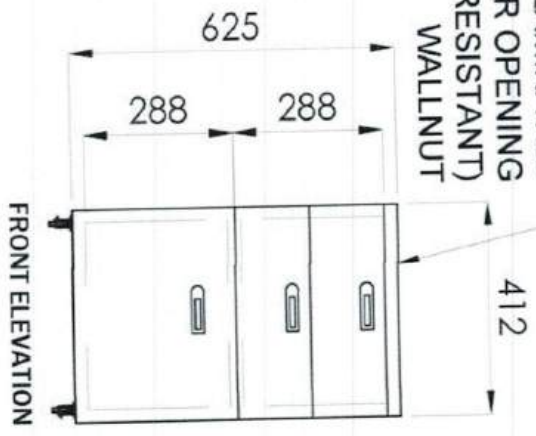

**VM STAFF MOBILE PEDESTAL (4 UNITS)**

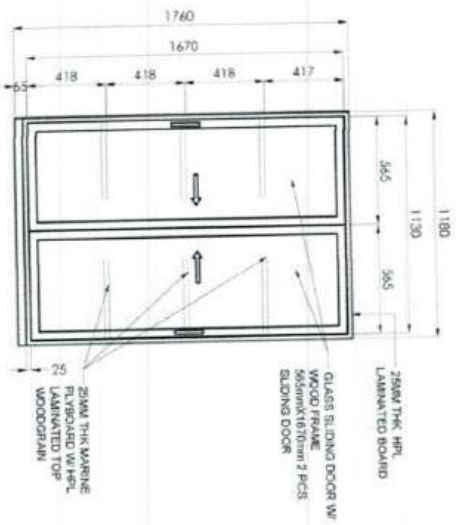
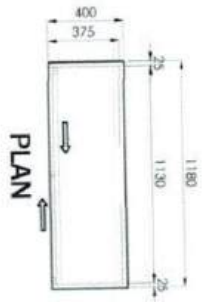

FRONT ELEVATION

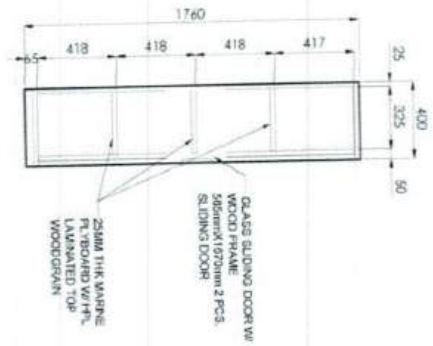

SIDE ELEVATION



PERSPECTIVE

**ADJUSTABLE SHELF**  
**VM - STAFF 2 UNITS**

**STAFF CHAIR;**

Ergonomic Designed Chairs with armrest, lockable rocking/tilting mechanism, with at least 50mm thick seat cushion made up of high density foam in fully upholstered black fabric, Backrest made up of mesh fabric, chrome base, backrest shall be bolted with sit and not welded, minimum weight capacity 350 lbs, can swivel 360 degrees.

Seat-W-49 x 52 x

H-90-102cm

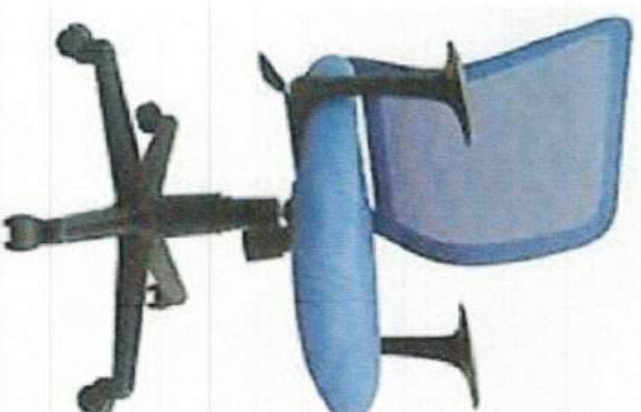

**VM - STAFF CHAIR (4- UNITS)**

**VISITOR CHAIR:**

High density foam on flame retardant, rust & stain resistant black upholstery fabric seat and Mesh backrest (black) Leg: Chrome Sledbase: Backrest Height: Low backrest Others: With fixed armrest, square edge backrests



**VM STAFF VISITOR CHAIR (3 UNITS)**

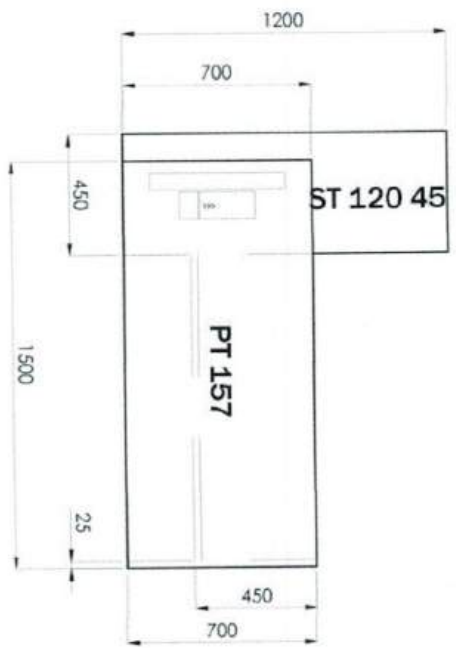

PLAN



PERSPECTIVE

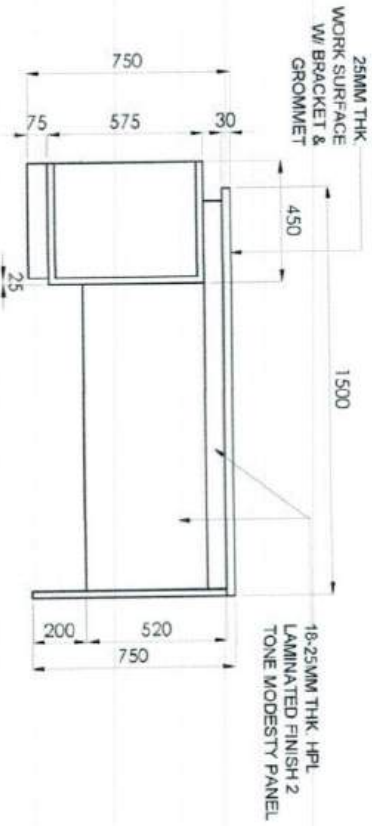

FRONT ELEVATION

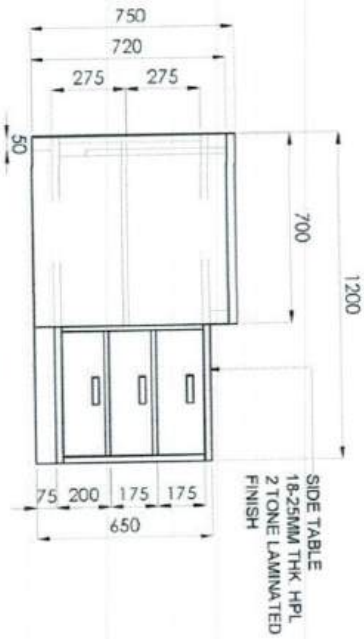

SIDE ELEVATION

# SANGGUNIAN SECRETARY TABLE LAYOUT

1 - UNIT

**EXECUTIVE CHAIR:**

Ergonomic Designed Chair with Armrest, lockable rocking/tilting and adjustable seat height using gas lift mechanism, with at least 50mm thick seat cushion made up of high density foam in fully upholstered black fabric, Backrest made up of mesh fabric, chrome base, backrest shall be bolted with sit and welded, can swivel 360 degrees. Black mesh, D-60cm, W-62cm, H-111-121cm.



**SP SECRETARY (1 - UNIT)**

**VISITOR CHAIR:**

High density foam on flame retardant, rust & stain resistant black upholstery fabric seat and Mesh backrest (black) Leg: Chrome Sledbase: Backrest Height: Low backrest Others: With fixed armrest, square edge backres



**SP VISITOR CHAIR (2 - UNITS)**

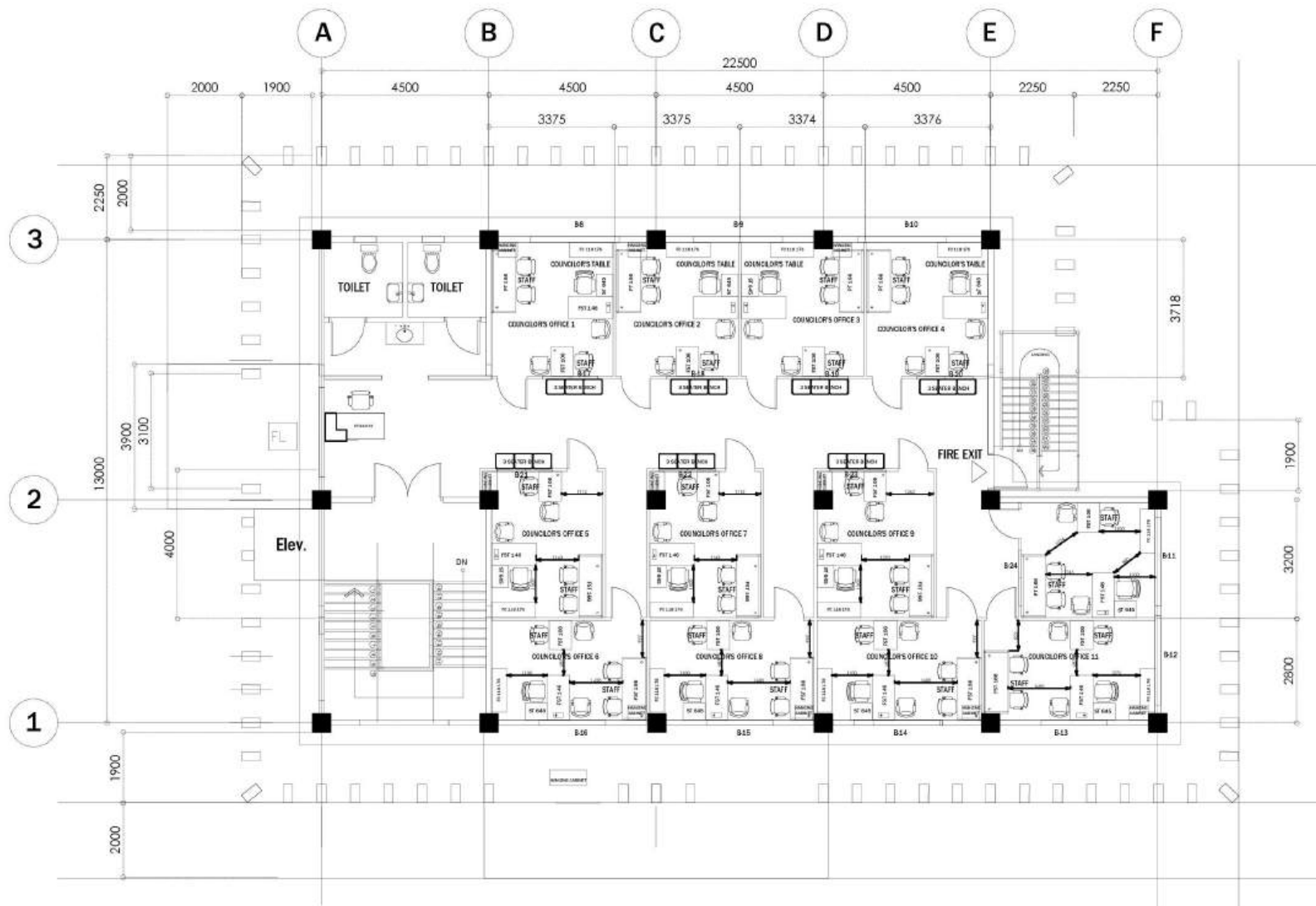

**SECOND FLOOR FURNITURE LAYOUT**

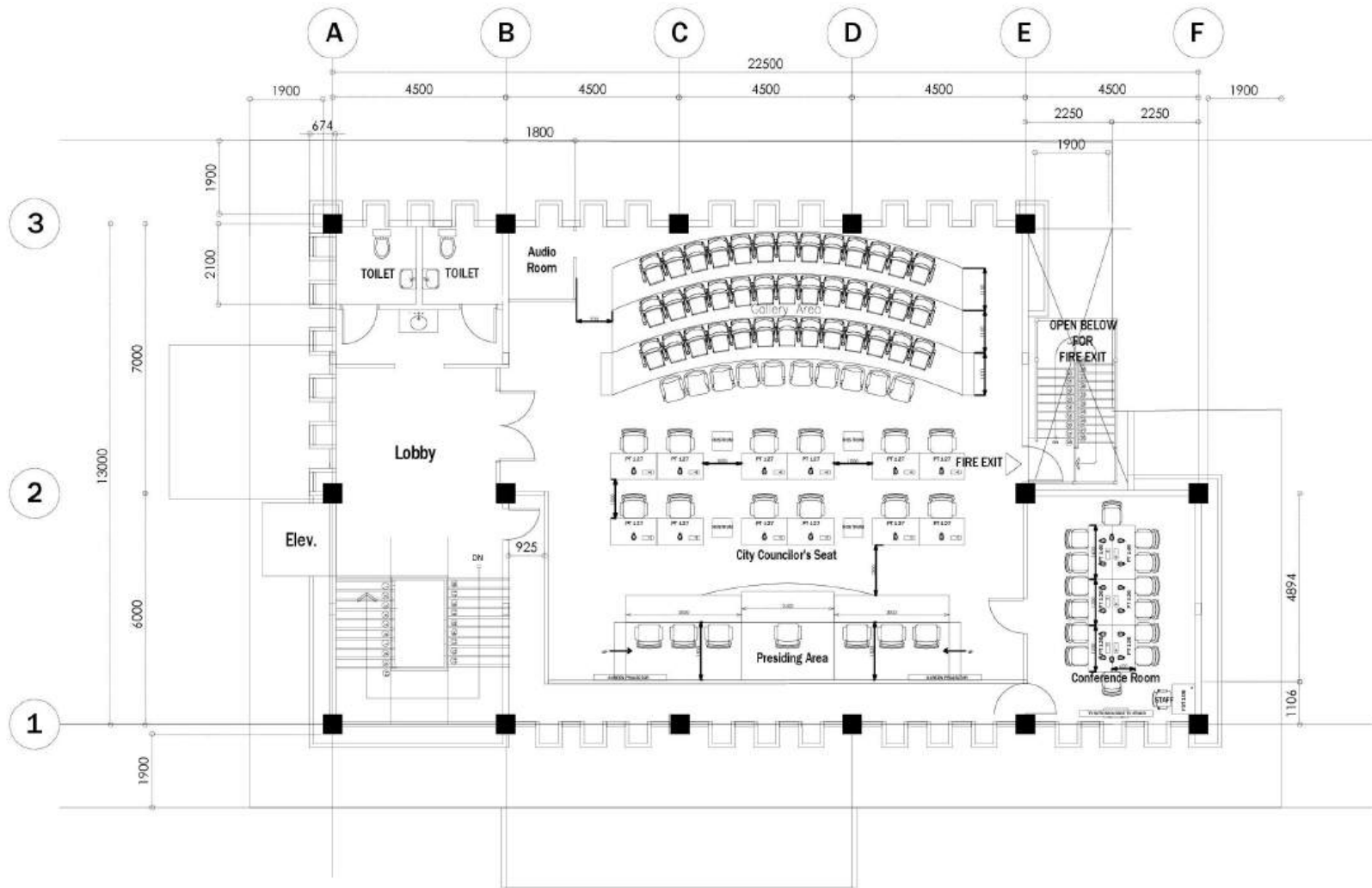

**THIRD FLOOR FURNITURE LAYOUT**